



***2-in-1 BLADELESS FAN
WITH AIR PURIFIER***
OWNER'S MANUAL

CONDURA

IBA ANG PINOY

CONTENTS

SAFETY INSTRUCTIONS	1
PARTS	3
NOTE BEFORE USE	4
OPERATION INSTRUCTIONS	5
WI-FI OPERATION	9
CLEANING & MAINTENANCE	16
TROUBLESHOOTING	19
PRODUCT SPECIFICATIONS	21

SAFETY INSTRUCTIONS



WARNING!

- Read all instructions carefully before using this product.
- This product is not to be used by children or persons with reduced physical, sensory, mental capabilities, or lack of experience and knowledge, unless they are supervised by a person responsible for their safety.
- Mind your children, and DO NOT let children play with this product.
- Cleaning and user maintenance of the appliance must not be done by children without adult supervision.
- Check the voltage indicated on the rating label before using this product.
- This product is for domestic indoor use only.
- If the power cord is damaged, contact ConcepStore Aftersales Team to avoid hazards.
- Unplug this appliance from the power outlet before cleaning and maintenance.
- Contact ConcepStore Aftersales Team for repair or maintenance of this appliance.
- Prolonged exposure to UV Rays can cause irritation to the skin and eyes. Do not open the top cover when the appliance is in operation.



WARNING!

- To avoid fire, electric shock, and injury, you must meet the following requirements. Otherwise, please follow the respective national and local electricity regulations.
 - DO NOT open the top cover and look directly at the UVC lamp, as it may be damaging to your eyes.
1. The children, the elderly, people with disabilities or without experience should be looked after by a person responsible for their safety when using this product. Children must be supervised by an adult to ensure that they do not play with the product as a toy.
 2. Please use a separate power outlet according to the current/voltage of the product. DO NOT use a multi-purpose socket for simultaneous use with other electrical devices.

3. If the fan does not work due to a damaged power cord, turn off the power and ask ConcepStore Aftersales Team for further assistance.
4. DO NOT move the fan when you pull the plug out of the electrical socket.
5. DO NOT pull out the plug by the cord. Pull out the plug and do not grip at the power cord.
6. DO NOT operate the appliance with a damaged power cord or connector. Please contact ConcepStore Aftersales Team to replace or repair the power cord that is damaged.
7. DO NOT stretch or energize the power cord. Keep the power cord away from the heat source.
8. DO NOT run the power cord under carpets, DO NOT cover it with carpets or similar covers. Route the power cord outside the traffic area to avoid tripping it.
9. Turn off all controls before pulling the plug and pull the plug out of the socket if you will not use the product for a long time.
10. DO NOT place any objects on the air inlet or outlet. Make sure that the ventilation openings are free of dust, lint, hair, and other obstacles that could impair the airflow.
11. The appliance should be positioned on a horizontal surface, free from any heat sources, and in a corrosive or wet environment. A 150 mm. radial distance must be kept around the appliance to ensure clear and good air passage.
12. DO NOT use the fan outdoors or on a wet surface.
13. DO NOT immerse the fan, power cord, or plug in water or other liquids to avoid danger. The use of an extension cord is not recommended unless it has been tested by a qualified person.
14. DO NOT use an air cleaner or similar product right next to the fan.
15. DO NOT use any cleaning agents or lubricants for this fan and pull out the power plug before cleaning, transporting, and servicing the device.

PARTS

BODY

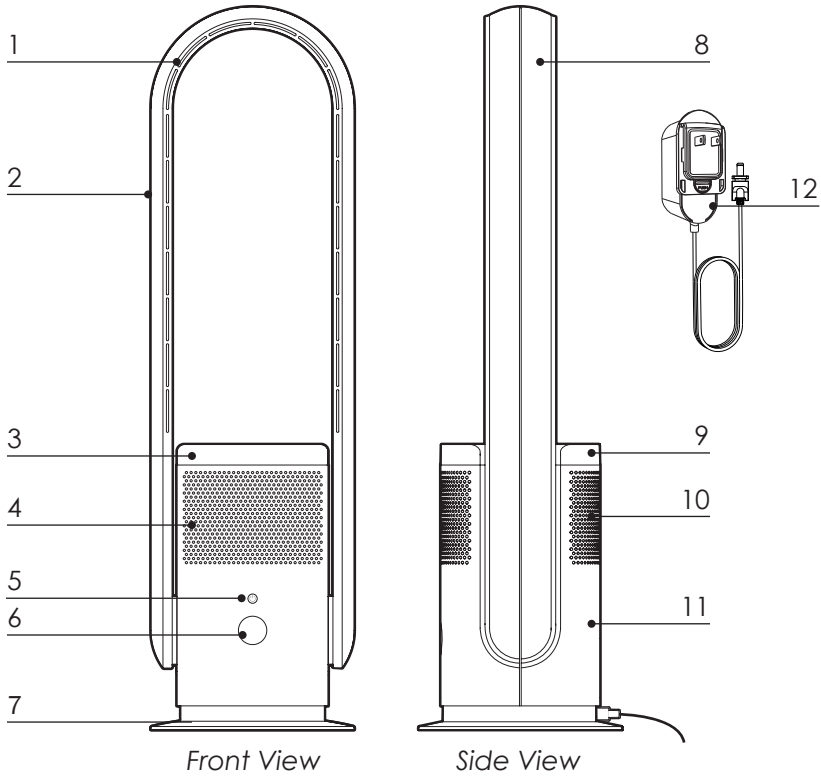

1. Air Outlet	7. Base
2. Air Duct	8. Air Duct
3. Top Cover of The Air Purifier Filter	9. Top Cover of The Air Purifier Filter
4. Air Inlet	10. Air Inlet
5. On/Off Button	11. Body
6. LED Display	12. Power Adapter

NOTE BEFORE USE

INSTALLATION

- Always use the appliance on a flat surface. DO NOT place it on an unstable surface, such as an inclined or soft surface, to avoid damage or malfunction caused by the appliance tipping over.
- DO NOT block the air inlet when using the appliance. Place away from curtains to avoid objects blocking the air inlet and causing the appliance to malfunction.
- DO NOT place any object within 30 cm. of the air outlet. If not, the air volume will be impaired.

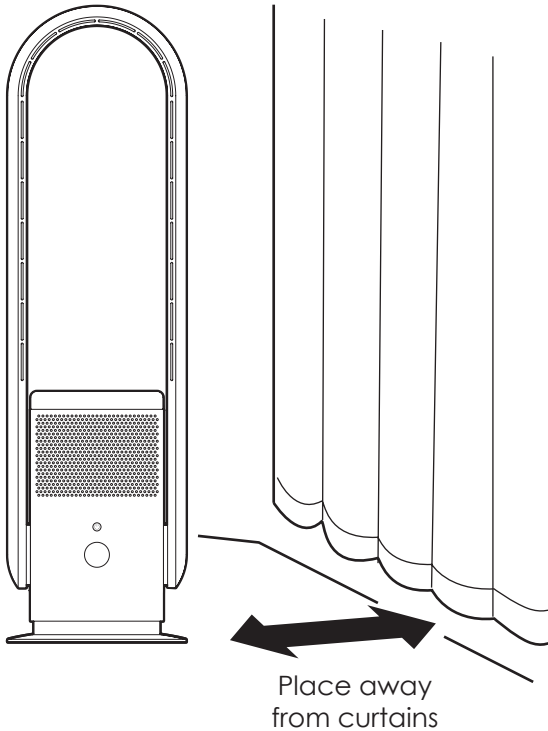

OPERATION INSTRUCTIONS

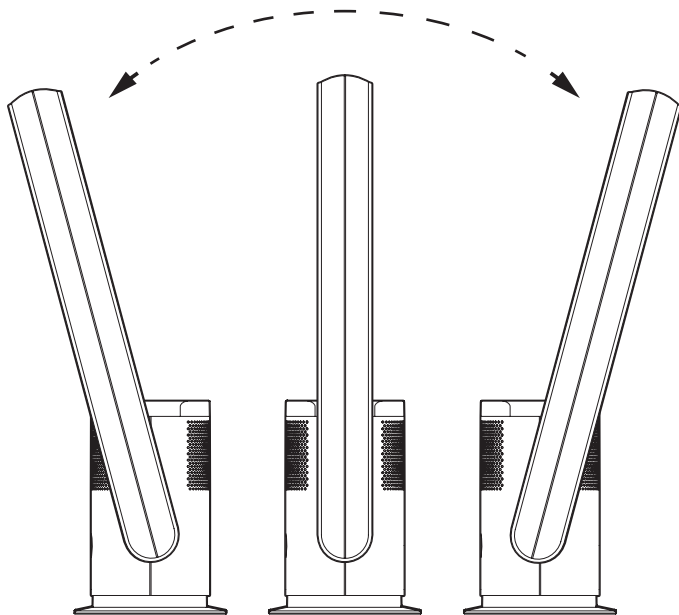

AIR DUCT ANGLE SETTING







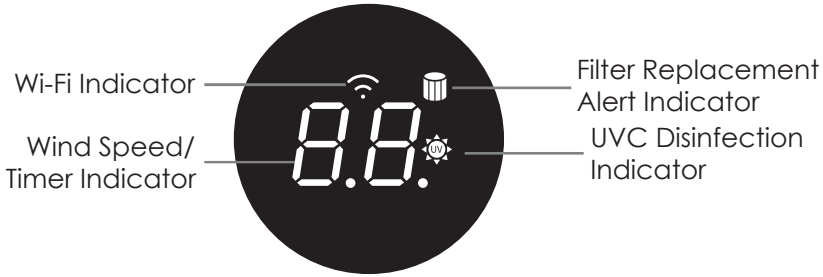

Before adjusting the air duct angle, make sure the appliance is turned off. Hold the body with one hand and set the air duct 15° forward or backward.

SWITCH ON AND OFF

1. Connect to a power source, and the appliance will enter into Standby Mode.
2. Press On/Off (🔌) button, the buzzer will beep once, and the appliance will start to operate.
3. To turn off the appliance, long-press On/Off (🔌) button for 2 seconds, then the buzzer will beep twice, and the appliance will stop operating.

LED DISPLAY PANEL



Icon	Description
	<p>On/Off Button</p> <ul style="list-style-type: none"> • Press to turn the appliance on. • Press repeatedly to adjust air volume. • Long-press for 1 second to turn Oscillation on and off. • Press 5 seconds to enter into Wi-Fi pairing mode.
	<p>Filter Replacement Alert Indicator</p> <p>After a total of 720 hours of operation, it will light up, indicating that the filter needs to be replaced. After the filter has been replaced, long-press On/Off () button of the Remote Control for 5 seconds, it will turn off, and the appliance will enter a new 720-hour cycle.</p>
	<p>UVC Disinfection Indicator</p> <p>When UVC Disinfection Function is turned on via the Remote Control, it will light up. UVC Disinfection Indicator will automatically turn off after 1 hour.</p>
	<p>Wi-Fi Indicator Light</p> <ul style="list-style-type: none"> • Long-press On/Off () button for 5 seconds, and it will quickly flash. Then, the user can connect the appliance through a smartphone application. • Long-press On/Off () button for 5 seconds again, then it will slowly flash, and the appliance runs in Compatibility Mode. When the appliance is successfully connected to the smartphone application, the Wi-Fi Indicator will light up. • Long-press On/Off () button for 5 seconds to cancel Wi-Fi connection.

Icon	Description
	<p>Wind Speed / Timer Display This indicates the current wind speed or timer.</p>

REMOTE CONTROL

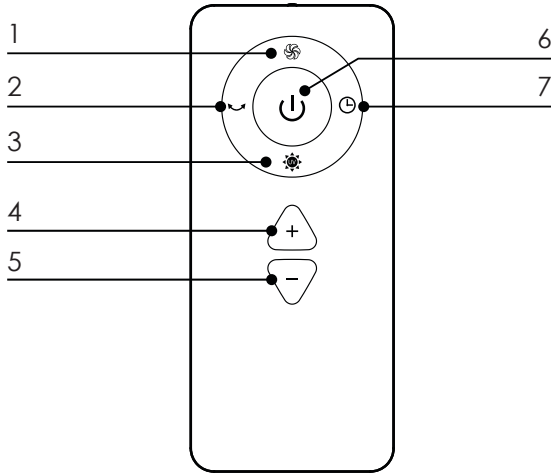

- | | |
|---------------------|---------------------|
| 1. Boost Mode | 5. Decrease Airflow |
| 2. Oscillate | 6. On/Off |
| 3. UVC Disinfection | 7. Timer |
| 4. Increase Airflow | |

NOTE:



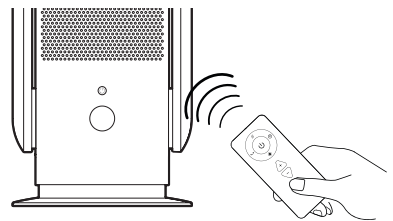



The Remote Control should be pointed directly at the Remote Control Signal Receiver on the LED Display Panel to maximize remote control reception.



ATTENTION:

The following phenomena may occur during operation:

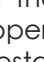
1. This appliance may respond to the remote control of other devices.
2. If you use the remote control of this appliance, other devices may respond due to overlapping frequencies of the Remote Control. There is no quality problem with the appliance itself. Keep the Remote Control away from other electrical devices during operation to avoid any interference.

<i>Icon</i>	<i>Function</i>	<i>Description</i>
	On/Off	<ul style="list-style-type: none">• In Standby Mode, press once to turn on the appliance.• When the appliance is operating, press once, and the appliance will turn off and return to Standby Mode.
	UVC Disinfection	<ul style="list-style-type: none">• Press once to turn on UVC Disinfection Function.• Press again to turn off UVC Disinfection Function (it will automatically turn off after operating for 1 hour).
	Boost Mode	Press this button, then the LED Display Panel will show "HH" and the wind speed becomes maximum.
	Oscillation	<ul style="list-style-type: none">• Press once to turn on Oscillation Function. The oscillation angle is at 80°±5°.• Press again to turn off Oscillation Function.
	Timer	<ul style="list-style-type: none">• Press once to set the countdown to turn off Time (1-8 hours). When the countdown completes, the appliance will automatically stop operating.• If the user wants to restart the appliance, press the On/Off () button.
	Speed	<ul style="list-style-type: none">• Press the Increase Airflow (+) button to increase wind speed; press the Decrease Airflow (-) button to decrease wind speed.• This appliance is equipped with 9 wind speed levels.

WI-FI OPERATION

OPERATING THROUGH SMART LIFE

Download and install Smart Life App.

Use your smartphone to scan the QR code below to download the Smart Life App.



Or search Smart Life in either Apple Store or Google Play to download and install the App.

Step 1

Run the Smart Life App and register a new account or log in with your existing account and password. You will need to add your Smart Fan to the same WiFi Router as your phone by following the below instructions.

Step 2

Open the App and tap Add Device or “+” icon to add a device. Select Small Home Appliance in the list of devices, and tap the Fan icon.

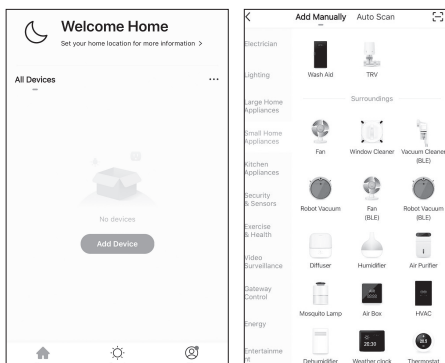

Step 3

Make sure that the power is connected to the bladeless fan before use. Plug the bladeless fan into the power outlet. Then, press and hold the power button for 5 seconds. Ensure your phone is connected to your local 2.4GHz Wi-Fi router.

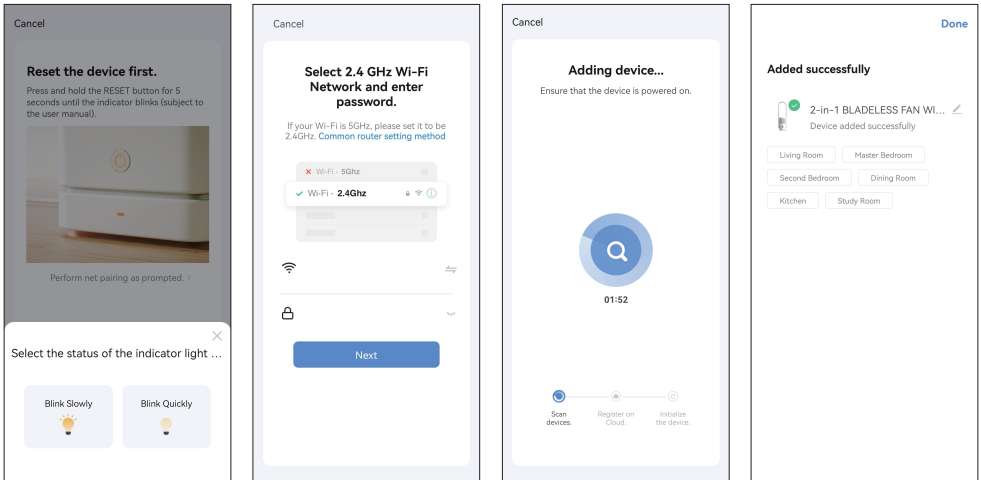

Step 4

The LED display will indicate the Wi-Fi symbol, and it will flash quickly. Tap “confirm indicator rapidly blink”. Type in your Wi-Fi password and tap Confirm to search the device. Once the configuration is complete, the indicator light will stop blinking rapidly.

Step 5

Continue long-press the On/Off (⏻) button on the LED display for another 5 seconds. Then, the LED display will indicate the Wi-Fi (📶) symbol, and it will flash slowly. If not, try again. The network connection is compatible if the indicator flashes slowly. Kindly check the router or network configuration.

NOTE: If the bladeless fan failed to establish a connection, make sure there is no special symbol in your Wi-Fi name (should only contain letters and numbers) and password, and try again by repeating Step 4 & Step 5 to set it up.

Step 6

Once connected, you can rename the bladeless fan and select the Room (e.g., Living Room) where the bladeless fan is located. It helps you identify the device when you want to cast to it.

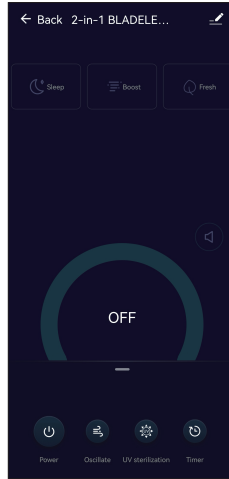
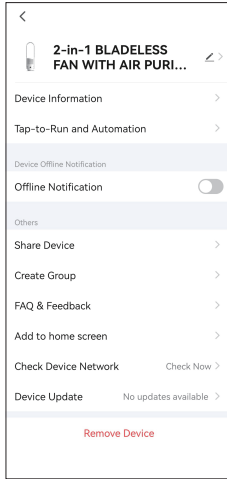

Step 7

You can tap the Power icon to turn on/off the bladeless fan. Swipe the Blue Circle to adjust the fan speed. Tap Oscillate to adjust the oscillation. Tap Boost to set your wind speed to maximum. Tap Time to set the time between 1 to 8 hours.

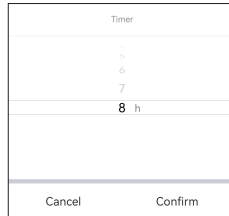
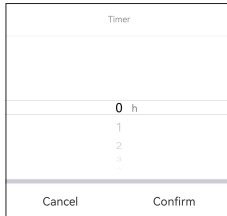

OPERATING THROUGH AMAZON ALEXA @ ECHO DOT

The bladeless fan works seamlessly with Alexa to give you hands-free voice control.

Step 1

Link the Smart Life account to Alexa. Run Alexa App and connect your Echo dot. Go to the Home menu. Tap “Skills” or “Skills & Games” in the Home menu and search “Smart Life” in the search window. Select “Smart Life” and tap “Enable” to enable the Smart Life skill.

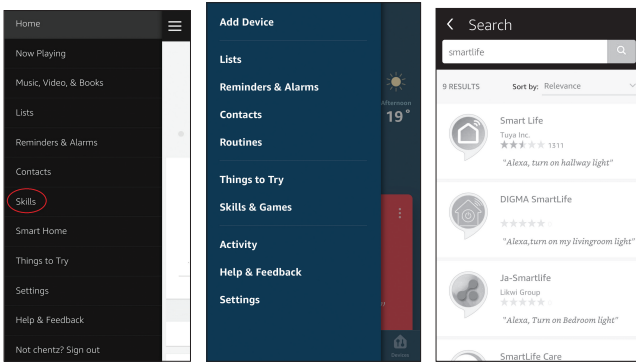

Step 2

Select your country code, and enter your Smart Life App Login and Password. Tap the Link Now button. Choose “Smart Life” and tap Link Now again. Then, tap the Authorize button. Wait until the prompt, “Alexa has been successfully linked with Smart Life” pops up.

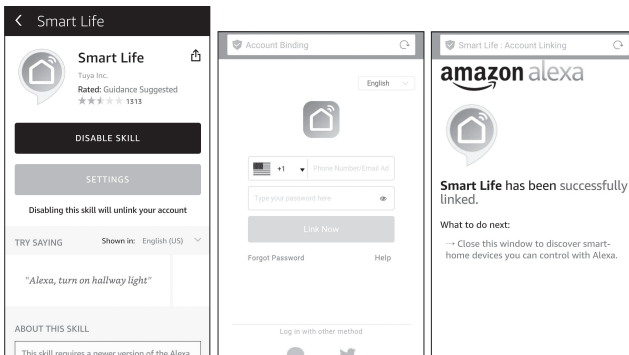

Step 3

Go back to the menu, tap the Smart Home button, and choose Devices. Then, tap the Discover button.

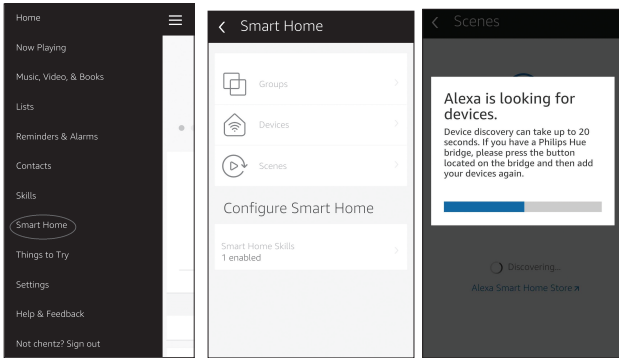

Step 4

Your device is connected successfully if you find the device in the Devices list. You can use your echo dot through Alexa to control your Smart Lamp by voice now.

Control your bladeless fan with via Amazon Alexa

When the accounts have been successfully linked, you can use your smart products via control the Amazon Alexa device by voice command, e.g .:

Hi Alexa, turn on the "device name" // Hello Alexa, turn on the "device name"

Hi Alexa, turn off the "device name" // Hello Alexa, turn off the "device name"

Hi Alexa, set the "device name" to 9 speeds //

Hello Alexa, set the "device name" to 9 Speeds

Hi Alexa, increase/decrease the "device name" speed // Hello Alexa, increase / decrease the Speed of the "device name"

NOTE: Device Name is the name assigned by the user. For example, set the device name as a "fan".

NOTE: Echo needs to discover your smart devices before it controls them. You can say, "Alexa, discover devices" to Alexa. Alexa will discover devices in about 20 seconds. You can now control your smart devices through Echo.

OPERATING THROUGH GOOGLE HOME

The bladeless fan works with the Google Assistant, allowing you to control your device by using your Google Home devices, your Android phone or iPhone, or any other device with built-in Google Assistant support. You will enjoy seamless, intuitive voice control to this Smart Fan.

Step 1

Open Google Home App by tapping the app icon on your device. Tap “Sign up” and choose one Google account that you already logged in on your mobile device. Find and tap “Settings” from the Home page. And then tap “More Settings.”

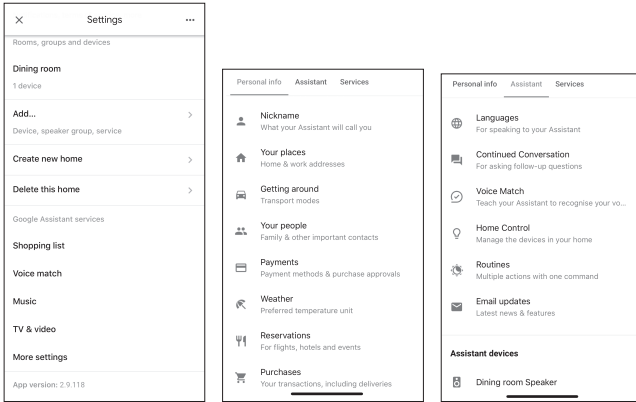

Step 2

Tap “Assistant.” Tap “Home Control.” Tap “+” and find “Smart Life” in the list. In the input window, select your Smart Life account's region type, and input your account and password. The link tab will be highlighted.

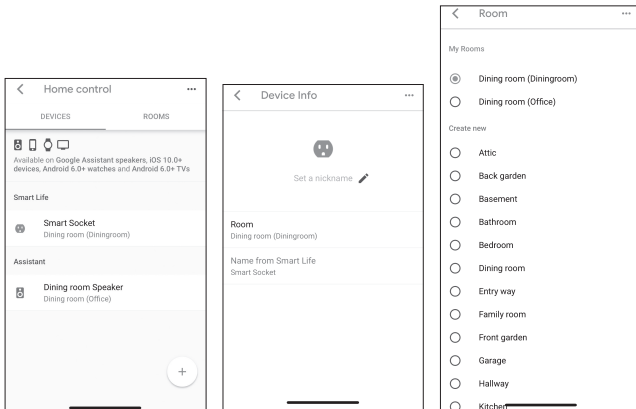

Step 3

Tap “Link Now.” After linking, select the Room (ex Living Room) where your Smart Fan is located. It helps you identify the device when you want to cast to it.

Step 4

Your devices will be listed on the Home Control page, and now you can control your Smart Fan through Fan Home. You can now activate Smart Lamp ON/OFF via voice instructions to Google Home Device.

Control your bladeless fan via Google Home

Now you can use your Google Home device to control your products using voice commands, e.g.:

Hey Google, turn on the “device name” // Hey Google, turn on the “device name”

Hey Google, turn off the “device name” // Hey Google, turn off the “device name”

Hey Google, set the “device name” to 9 speeds // Hey Google, set the “device name” to 9 Speeds

Hey Google, increase/decrease the “device name” speed // Hey Google, increase / decrease the speed of the “device name”

NOTE: Device Name is the name assigned by the user. For example, set the device name as a “fan”.

CLEANING & MAINTENANCE

BATTERY REPLACEMENT

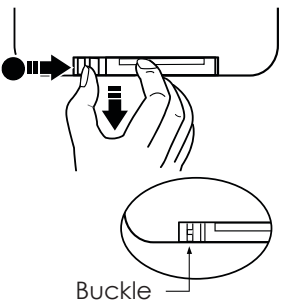
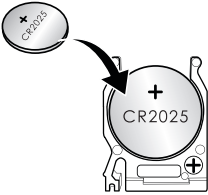
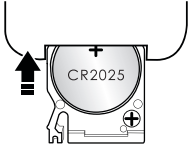
 <p>Buckle</p>		
<p>Step 1 To open the battery cover at the bottom of the Remote Control, press the buckle on the battery cover inward and pull it out.</p>	<p>Step 2 Identify the polarity of the battery, and insert the battery into the battery slot.</p>	<p>Step 3 Reinsert the battery cover into the bottom of the Remote Control.</p>

ATTENTION:

1. If the Remote Control will not be used for a prolonged period, please remove the battery.
2. This battery is not rechargeable. DO NOT recharge the battery.
3. The Remote Control and battery are not toys. Please keep them out of children's reach.
4. If the battery is swallowed by accident, please seek medical attention immediately.

WARNING!

- Before cleaning and maintenance work, unplug the appliance from the power outlet.
- DO NOT wash the HEPA filter with water or any liquid. DO NOT immerse the HEPA filter in water or any liquid.
- DO NOT place the appliance and HEPA filter in areas with high humidity.

FILTER REPLACEMENT

This appliance is equipped with a HEPA 13 filter that traps 99.9% of airborne particles. Please install the HEPA filter into the appliance before use. Under normal usage, the filter can last for 3 to 6 months. When the Filter Replacement Alert Indicator on the LED Display Panel lights up, please change the HEPA filter.

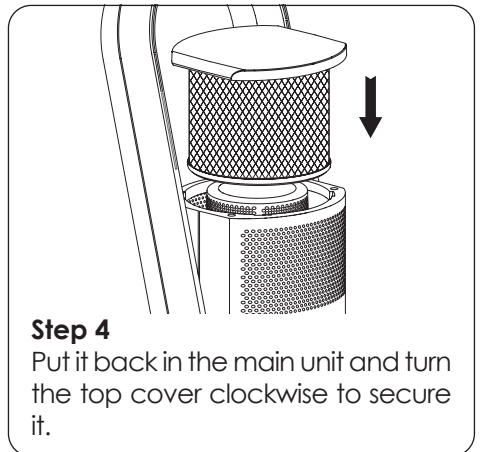
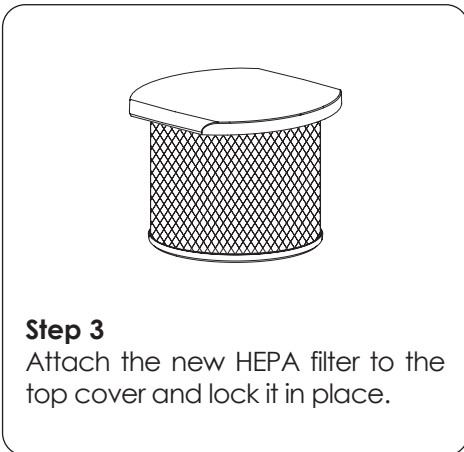
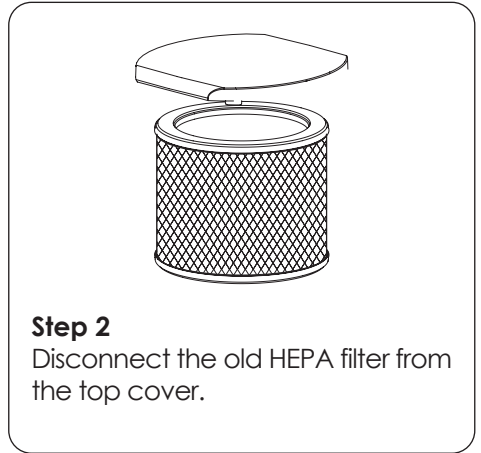
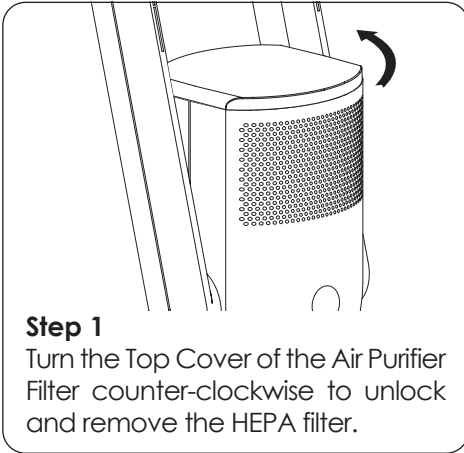

PRODUCT SURFACE

- When cleaning the appliance, DO NOT soak or splash water on the appliance to avoid the water entering inside and causing malfunction.
- DO NOT use banana oil, benzine, alcohol, bleach, or metal objects to wipe the surface of the appliance, which may damage the surface or cause discoloration.
- Use a soft dry cloth to wipe the surface of the appliance.
- If the surface is heavily stained, use a soft cloth and diluted mild detergent to clean, then wipe dry with a soft dry cloth.

AIR INLET & AIR OUTLET

Use a soft brush or vacuum cleaner to regularly clean off any dust accumulated on the Air Inlet and Outlet. DO NOT let the dust build up as too much dust will reduce the efficiency of the appliance.

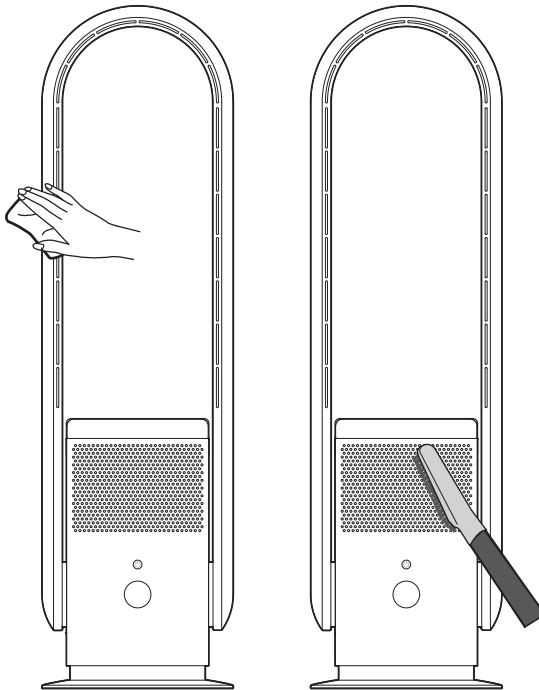

REMOTE CONTROL

Gently wipe the surface of the Remote Control with a soft dry cloth. If the Remote Control will not be used for a prolonged period, please remove the battery to avoid battery consumption.

POWER PLUG

Use a soft dry cloth to clean the power plug.

STORAGE

- After cleaning the appliance, put it in a plastic bag and store it in a cool, dry place.
- Avoid storing the appliance in an area with vibration (e.g., car trunk) heated or cooled by another appliance.
- Avoid placing the appliance in direct sunlight or a hot and humid environment.
- Keep this appliance out of children's reach.

TROUBLESHOOTING

WARNING!

- Before conducting any maintenance work, turn off the appliance and unplug it from the power outlet.
- This appliance must be installed, repaired, or replaced by ConcepStore Aftersales Team only. If the consumer entrusts personnel not authorized by ConcepStore, or if the consumer performs reparation work on their own, there may be a risk of personal injury or property loss.

<i>Problem</i>	<i>Description</i>
Has plugged the appliance in the power outlet, but it does not work	Is the plug inserted properly into the power outlet?
Remote Control does not work	Is the battery dead? Is the battery inserted properly? Is the Remote Control aligned with the Signal Receiver?

ERROR CODE

Code	Problem	Possible Reason
E1	Under voltage protection	<ul style="list-style-type: none"> Induced by voltage too low 220V fan connected to 110V voltage Under bad AC terminal block connection during operation of the fan, the voltage of the electronic board may go too low Pulling the plug when the fan is operating at high speed because the fan motor is still heated, so the electronic board takes time to drop its electricity, inducing this problem. This is a natural occurrence. When plugged in again, the fan will operate normally. Electronic board defect
E2	High Voltage Protection	<ul style="list-style-type: none"> Induced by voltage too high 110V fan connected to 220V voltage Electronic board defect
E3	Blocked Rotor	<ul style="list-style-type: none"> Rotor installed incorrectly, fan blade blocked Poor connection between rotor terminal block and electronic board Rotor defect or disconnection Rotor terminal block of the electronic board defect, poorly welded or terminal block pin missing Electronic board defect: circuit driver, power component (MOSFET) or other components damaged by outer forces; Electronic board parameter error
E4	Hardware Overcurrent	<ul style="list-style-type: none"> Short circuit of fan rotor or inner rotor Electronic board defect: driver error or power component (MOSFET) error Incorrect rotor usage: using low voltage rotor on high voltage driver
E5	Software Overcurrent	<ul style="list-style-type: none"> Electronic board defect: current sampling circuit error

<i>Code</i>	<i>Problem</i>	<i>Possible Reason</i>
E6	Default Phase of Rotor	<ul style="list-style-type: none"> • Rotor disconnection • Poor connection between rotor and terminal block • Electronic board defect: driving error of the driver
E7	Communication Error	<ul style="list-style-type: none"> • Poor communication between display board and motherboard, poor cable connection, cable terminal block installation error • Poor connection between rotor and terminal block • Electronic board defect: driving error of the driver
E9	Temperature-sensor probe not connected	<ul style="list-style-type: none"> • Temperature-sensor probe plug-in failure • Electronic board defect • Temperature-sensor probe defect

PRODUCT SPECIFICATIONS

Product Name	Condura 2-in-1 Bladeless Fan with Air Purifier
Model Number	CBF86D0W0
CADR	86 m ³ /h
Power	35 W
Voltage and Frequency	100-240V~50/60Hz 1Ph
Unit Dimensions	235 x 235 x 800 mm.
Net Weight	3.5 kg.
Gross Weight	5.0 kg.

All information in this owner's manual is for reference only. If there are any errors or omissions, the specification produced by the factory shall prevail. The specification is subject to change without prior notice.

Customer Care

We are committed to serve.

QUESTIONS ABOUT YOUR CONDURA 2-in-1 BLADELESS FAN WITH AIR PURIFIER

Please feel free to e-mail us at
help@concepstore.com

You can also visit us at
www.concepstore.com



CONCEPCION DURABLES INCORPORATED
CUSTOMER SERVICE DEPARTMENT

308 Sen. Gil Puyat Avenue, Makati City
Trunk Line: (02) 8 863 5555
TOLL FREE: 1800 10 888 8888
Mobile Nos.: 0917 536 3030 (Globe)
0947 996 2415 (Smart)

PO BOX 211 COMMERCIAL CENTER
MAKATI CITY

BUSINESS REPLY!
Permit No. 2416A!
NO STAMP NEEDED

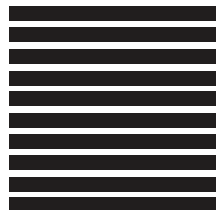

CONDURA

PRODUCT WARRANTY CERTIFICATE

IMPORTANT: PLEASE READ CAREFULLY

Concepcion Durables, Inc. ("CDI") warrants to the purchaser that this CONDURA 2-IN-1 BLADELESS FAN WITH AIR PURIFIER will be free from defects in material and workmanship, and agrees to repair or replace any defective part or unit with a new or equivalent part or unit through any of its Authorized Service Centers if such defect is found to be manufacturer's error and in accordance with the terms of this warranty, subject to the following conditions:

1. COVERAGE OF WARRANTY

Applicable for Condura 2-in-1 Bladeless Fan with Air Purifier

2. WARRANTY PERIOD (from the date of original purchase)

Full replacement guarantee against factory defect subject for technical assessment (actual or virtual)..... 1 Year

CDI warrants this 2-in-1 Bladeless Fan with Air Purifier to the original purchaser/user to be free from defects in materials and workmanship under normal use.

CDI shall, at no cost to the original purchaser/user, repair or replace the unit or any of its parts that is found by CDI to be defective within the Warranty Period, with original or equivalent unit or parts, subject to the conditions and exclusions provided below.

3. LIMITATIONS

This warranty is not transferable, valid only in the Philippines. This warranty shall be void if the unit is:

- Improperly installed or mounted, or subjected to misuse, abuse, neglect, accident, alteration, or abnormal voltage conditions
- Plugged into any device other than a suitable power supply outlet
- Serviced, opened, dismantled, disassembled, or reassembled by anyone other than a CDI accredited service center
- Damaged in transport or subjected to rough handling
- Damaged due to rodent, pest, or related infestation
- Damaged due to commercial use (stores, restaurants, other businesses, and non-household application)
- Damaged due to accidents, flood, fire, etc.

This warranty does not cover breakable parts and accessories, and any damages due to wear and tear.

The above warranties are given by CDI in lieu of any other warranties, express or implied. CDI and its vendors disclaim any implied warranty of merchantability or fitness for a particular purpose, or any similar standard imposed by applicable legislation. CDI's responsibility to repair, replace or offer a refund for defective units, parts and related items is the sole and exclusive remedy provided for breach of these warranties.

MODEL NO. CBF86D0W0 **SERIAL NO.**

NOTE: Keep this warranty card together with your Original Sales Invoice/Official Receipt as proof of purchase. If the date of purchase cannot be proven, warranty shall be based on CDI's Invoice to Dealer.



Fill out this warranty card completely and mail within 15 days from date of purchase. This will activate your warranty.



MODEL NO. CBF86D0W0 **SERIAL NO.**

DEALER (Please indicate branch)

DATE OF PURCHASE **DEALER INVOICE NO.**

CUSTOMER NAME **EMAIL ADDRESS**

ADDRESS

TELEPHONE NO. **MOBILE NO.**

CONDURA
IBA ANG PINOY

www.concepstore.com

