



3-IN-1 HAND BLENDER **OWNER'S MANUAL**

CONDURA
IBA ANG PINOY

SAFETY PRECAUTIONS

When using electrical appliances, basic safety precautions must be followed to reduce the risk of fire, electrical shock and injury to persons or properties. Read all instructions before using your Condura 3-in-1 Hand Blender.

Note: This product is for household use only. This hand blender is designed to blend or chop fruits and vegetables, to chop meat, to beat eggs, batter and the like.

1. Read and understand all instructions.
2. Before connecting the appliance to a power supply, make sure that the voltage stated on the rating label of the appliance corresponds with the voltage in your home.
3. Only connect the appliance to a grounded power outlet.
4. Ensure that the plug is inserted firmly into the power outlet.
5. Do not allow the cord to get in contact with hot surfaces, carpets or other heat insulators.
6. Keep the power cord out of children's reach. Do not let the power cord hang over the edge of the table or countertop where the appliance stands.
7. As protection against fire, electric shock and injury to persons, do not immerse the appliance, cord and plug in water or any other liquid.
8. Do not insert the plug into the power outlet with wet hands.
9. Do not operate the appliance with wet hands.
10. Ensure that all parts are assembled before operating the appliance.
11. Do not operate the appliance near an open flame, cooling or other heating appliances.
12. Check the appliance for any damage before use. Do not operate any appliance with a damaged cord or plug, after the appliance malfunctions or has been damaged in any manner. Contact Condura's customer service hotline for examination, repair or adjustment. Repairs and replacements must only be done by the manufacturer or Condura's service agents to avoid hazards. Do not dismantle or attempt to repair the appliance yourself.
13. The use of accessories not recommended by the manufacturer may result in fire, electric shock or injury to persons. Do not use other accessories to switch the appliance on/off.
14. Do not move the appliance while operating.
15. Do not use the appliance for any other use other than what it is intended for.
16. Do not use the appliance for mixing paint or other flammable substances, or in a location contaminated with flammable gases or vapor.
17. Do not leave the appliance operating while unattended.
18. Unplug from power outlet immediately after use, before assembling, disassembling and before cleaning. Ensure that the appliance is unplugged when not in use.
19. To disconnect, switch off the appliance and remove the plug from the power outlet. Always pull by the plug. Do not pull the cord.
20. Ensure that the motor has completely stopped before disassembling.
21. Do not blend hard ingredients and hot liquid.
22. The blender cup and chopping bowl are not microwaveable.

23. Care is needed when handling this appliance. Avoid touching sharp blades, especially during cleaning or while the appliance is still connected to the power outlet. Ensure that fingers are kept away from the blades when in use.
24. Avoid contact with moving parts. Keep hands, hair, clothing, as well as spatulas and other utensils away during operation to prevent injury and/or damage to the appliance.
25. Do not use abrasive cleaners or scouring pads on the appliance. To clean the exterior, wipe with a soft, damp cloth.
26. Close supervision is necessary when any appliance is used by or near children. Keep the appliance and its cord out of children's reach. Children should be supervised to ensure that they do not play with the appliance.
27. This appliance can be used by children ages 8 years and above, and persons with reduced physical, sensory or mental capabilities or lack of experience and knowledge if they have been given supervision or instructions concerning the use of the appliance in a safe way and understand the hazards involved. Children shall not play with the appliance. Cleaning and user maintenance shall not be made by children unless they are older than 8 and supervised. Children below 8 years of age shall be kept away from the appliance unless continuously supervised.
28. Children must not play with the appliance.
29. This appliance is intended to be used in household and similar applications such as:
 - a. staff kitchen areas in shops, offices and other working environments;
 - b. by clients in hotels, motels and other residential type environments;
 - c. farm houses;
 - d. bed and breakfast type environments.
30. This appliance is designed for indoor use only. Do not use the appliance outdoors.
31. Save these instructions for future reference.

PARTS

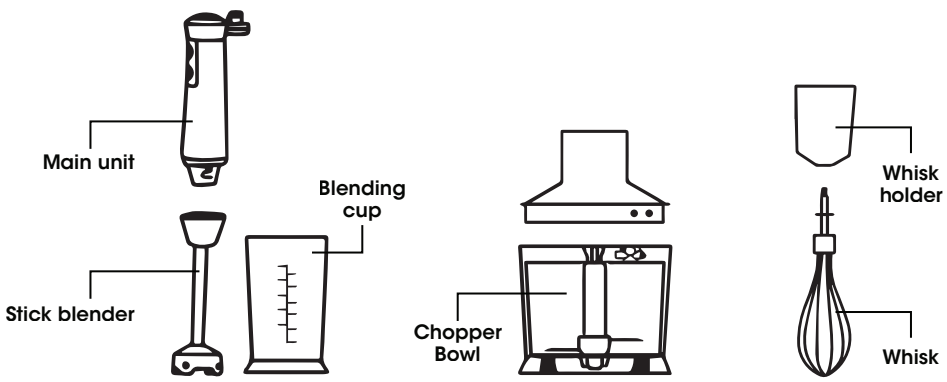

PRODUCT SPECIFICATIONS

| | |
|----------------|-----------|
| Model | CHB0M3SB0 |
| Rated Voltage | 230V~60Hz |
| Power Input | 500W |
| Product Weight | 1.25 kg |

BEFORE FIRST USE

1. Remove all accessories.
2. Clean the parts of the appliance before first use by following the steps under "Cleaning and Maintenance".
3. Make sure that all the parts are completely dry before using the appliance.
4. Before plugging the appliance to a power outlet, ensure that the parts are properly installed, and that it is switched off.

Note: To prevent injuries, exercise caution when cleaning/handling the stick blender and chopping blades.

OPERATING INSTRUCTIONS

STICK BLENDER:

Note: Do not operate the appliance for more than one minute at a time. Allow the appliance to cool down for at least ten minutes in between two consecutive operations. Failure to allow the appliance to cool down may lead to overheating and may cause damage to the appliance.

1. Peel or core the fruits/vegetables you wish to blend, and cut into smaller pieces (Max size: 15mm³). Place the cubed ingredients into the blending cup, and add your desired liquid (water, juice, milk, etc.). The amount of mixture should not exceed the 500mL mark on the blending cup.
2. Assemble the stick blender onto the main unit as shown below:

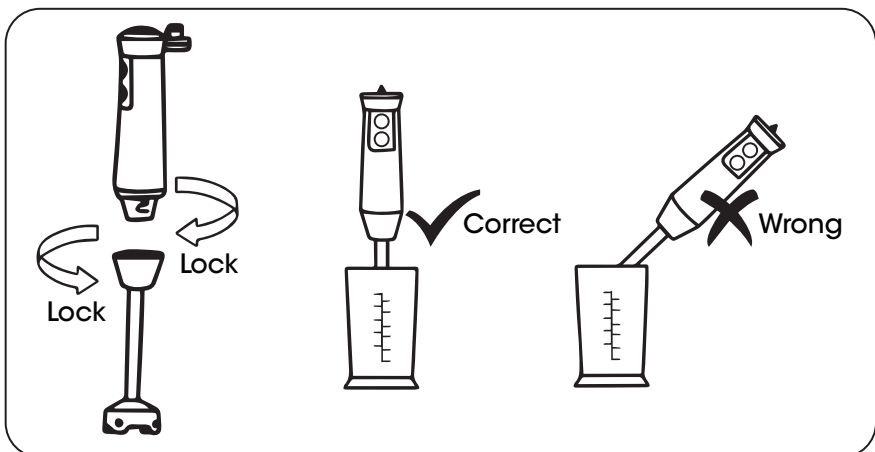

3. Ensure that all parts are properly assembled, then plug into an appropriate power outlet.
4. Place the stick blender onto the food, then press either the low speed or high speed switch (Turbo) to start operating. The speed setting can be adjusted through the adjustable speed knob under the low speed mode.
5. In order to prevent food splashes during operation, slowly and carefully move the blender up and down, and in circles. Hold the blender upright.
6. When blending is completed, release the button and unplug the cord from the power outlet.

Note: Do not stick knife, metal spoons, or any other utensil into the blending cup while operating.

FOOD PROCESSOR:

Note: Do not operate the appliance for more than 30 seconds at a time. Allow the appliance to cool down for at least ten minutes in between two consecutive operations. Failure to allow the appliance to cool down may lead to overheating and may cause damage to the appliance.

1. Place the chopper bowl on a clean and level surface.
2. Assemble the chopping blades into the chopper bowl as shown in fig. 1. Exercise extreme caution when handling sharp blades.
3. Place food into the chopper bowl. Refer to the chopping guide below).
4. Attach the lid onto the chopper bowl, and ensure that the tubes inside the bowl aligns with the groove of the lid. Put down the lid, and turn in a clockwise direction until locked in place (see fig. 2). To detach the lid, turn counterclockwise.
5. Insert the main unit into the hole of the chopper lid and turn in a clockwise direction to lock in place (see fig. 3).

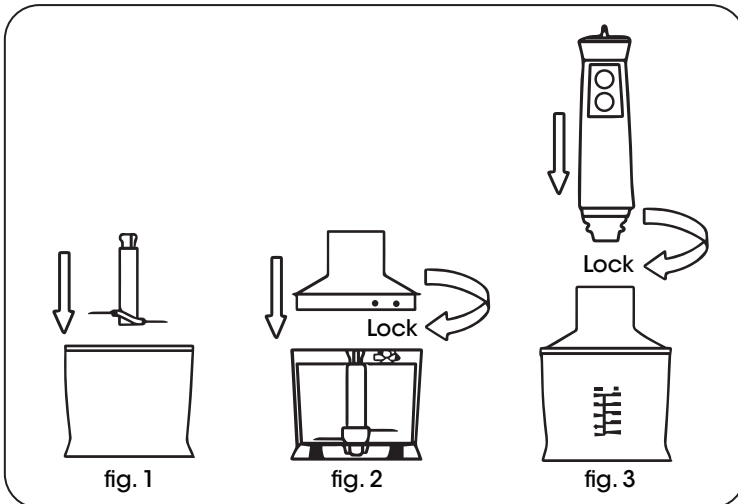

6. Ensure that all parts are properly assembled, then plug into an appropriate power outlet.
7. Press and hold the high speed (Turbo) switch to start operating. During operation, hold the main body with one hand, and the chopper bowl with the other.
8. Release the switch after chopping, or after 30 seconds have passed. Unplug after use.

Note:

- To reduce the risk of injury, do not assemble the chopping blades without the chopper bowl ready.
- Do not operate when empty.
- Ensure that the lid is securely locked in place before operation.
- After operation, remove the main unit from the chopper lid first. Do not remove the chopper lid while the main unit is still assembled. The blades are very sharp. Always hold by the plastic shaft when handling.

WHISK:

Note: Do not operate the appliance for more than one minute at a time. Allow the appliance to cool down for at least ten minutes in between two consecutive operations. Failure to allow the appliance to cool down may lead to overheating and may cause damage to the appliance.

1. The whisk should only be used for whipping cream, egg whites, light batter and ready-mix desserts. Do not use for heavier mixtures such as butter/margarine and sugar to avoid damaging the whisk.
2. Prepare your ingredients in a mixing bowl/container.
3. Insert the whisk into the whisk holder, then install the whisk holder onto the main unit until locked in place.

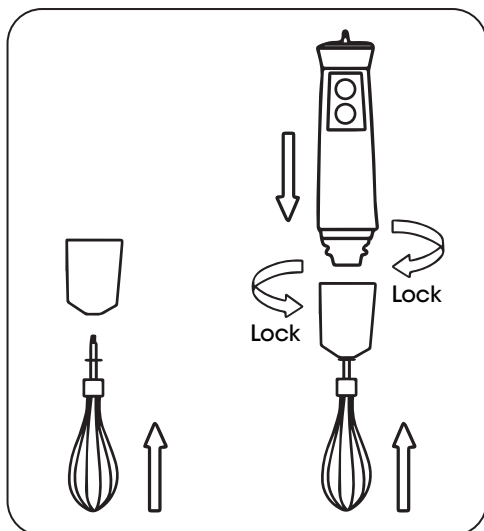

4. Ensure that all parts are properly assembled, then plug into an appropriate power outlet.
5. Place the whisk onto the ingredients, then press either the low speed or high speed switch (Turbo) to start operating.
6. While operating, hold the main unit with one hand and the mixing bowl with the other.
7. Release the switch after use, or after one minute has passed. Unplug after use.

CLEANING AND MAINTENANCE

Caution: Unplug the appliance and allow to cool down before cleaning. As protection against fire, electric shock and injury to persons, do not immerse cord or plug in water or any other liquid.

1. Wipe the main body with a damp cloth. Do not place the main body (motor) in a dishwasher, or immerse in water.
2. Wash the stick blender, wire whisk, chopping blades, bowl and blending cup dishwashing soap and warm water.
Note: The blades are very sharp. Exercise caution when handling the blades. Avoid touching sharp edges.
3. Allow all parts to completely dry, then store in a cool, dry place for your next use.

Note:

- Rinse the blades or the stick blender immediately after processing food with high salt content.
- Do not clean any part of the appliance in a dishwasher. Some food may cause discoloration to plastic parts. This is normal and will not affect the flavor of your food. You may try to wipe discolored parts with vegetable oil before washing.
- Do not wash with water above 50°C.
- Do not use paint thinner, benzene, metal wire brush, or any other chemicals as these may cause scratching and discoloration of the motor housing.

Customer Care

We are committed to serve.

QUESTIONS ABOUT YOUR CONDURA 3-IN-1 HAND BLENDER

Please feel free to contact any of our customer care hotline:

CUSTOMER SERVICE DEPARTMENT

GMA & LUZON Area

Address: 308 Sen. Gil Puyat Avenue, Makati City

Trunk Line: (02) 8 863 5555

TOLL FREE: 1800 10 888 8888

Mobile Number: +63 917 536 3030 (Globe) "SMS Only"

+63 947 996 2415 (Smart) "SMS Only"

Covered Region/Areas: National Capital Region (NCR), Ilocos Region (Region 1), Cordillera Administrative Region (CAR), Central Luzon (Region III), CALABARZON (Region IV-A), MIMAROPA except Romblon (Region IV-B), Bicol Region except Masbate (Region V)

Email Address: customer@condura.com

CEBU Regional Office

Address: Dr. A Esperanza Building, A.C Cortes Ave. Mandaue City

Telefax No: 032 328 1416

Mobile Number: +63 947 996 2416

+63 921 222 0942

TOLL FREE: 1800 10 888 8888

Covered Region/Area: Masbate, Central Visayas (Region VII), Eastern Visayas (Region VIII)

ILOILO Regional Office

Address: 109 Yulo Street, Brgy. Yulo-Arroyo, Iloilo City, Iloilo

Telefax No: 032 36 1121

Mobile Number: +63 947 996 2417

+63 999 925 5736

TOLL FREE: 1800 10 888 8888

Covered Region/Area: Romblon, Western Visayas (Region VI)

CAGAYAN DE ORO Regional Office

Address: No. 102 CKY Center, Capistrano-Chavez Street, CDO City

Telefax No: 08822 721 905

Mobile Number: +63 947 996 2419

+63 939 253 5011

TOLL FREE: 1800 10 888 8888

Covered Region/Area: Zamboanga Peninsula (Region IX), Northern Mindanao (Region X), Autonomous Region in Muslim Mindanao (ARMM) except Maguindanao, Agusan Del Norte, Surigao del Norte

DAVAO Regional Office

Address: 1C, Nand-Saling Building, Sobrecarey Street, Obrero, Davao City

Telefax No: 082 224 5040

Mobile Number: +63 947 996 2418

+63 922 294 1478

TOLL FREE: 1800 10 888 8888

Covered Region/Area: Davao Region (Region XI), SOCCSKSARGEN (Region XIII), Agusan Del Sur, Surigao del Sur, Maguindanao

All contact information detailed above may change without prior notice.



CONCEPCION DURABLES INCORPORATED

CUSTOMER SERVICE DEPARTMENT

308 Sen. Gil Puyat Avenue, Makati City

Trunk Line: (02) 8 863 5555

TOLL FREE: 1800 10 888 8888

Mobile Nos.: 0917 536 3030 (Globe)

0947 996 2415 (Smart)

PO BOX 211 COMMERCIAL CENTER

MAKATI CITY

BUSINESS REPLY!
Permit No. 2416A!
NO STAMP NEEDED

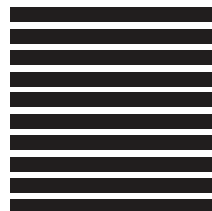

CONDURA

PRODUCT WARRANTY CERTIFICATE

IMPORTANT: PLEASE READ CAREFULLY

Concepcion Durables, Inc. ("CDI") warrants to the purchaser that this CONDURA 3-in-1 Hand Blender will be free from defects in material and workmanship, and agrees to repair or replace any defective part or unit with a new or equivalent part or unit through any of its Authorized Service Centers if such defect is found to be manufacturer's error and in accordance with the terms of this warranty, subject to the following conditions:

1. COVERAGE OF WARRANTY

Applicable for CONDURA 3-in-1 Hand Blender

2. WARRANTY PERIOD (from the date of original purchase)

System Parts and labor..... 1 Year

CDI warrants this 3-in-1 Hand Blender to the original purchaser/user to be free from defects in materials and workmanship under normal use for a period one (1) year from the date of purchase.

CDI shall, at no cost to the original purchaser/user, repair or replace the unit or any of its parts that is found by CDI to be actually defective within the Warranty Period, with original or equivalent unit or parts, subject to the conditions and exclusions provided below.

3. LIMITATIONS

This warranty is not transferable and is valid only in the Philippines. This warranty shall be void if the unit is:

- Improperly installed or mounted, or subjected to misuse, abuse, neglect, accident, alteration or abnormal voltage conditions
- Plugged into any device other than a suitable power supply outlet
- Serviced, opened, dismantled, disassembled, or reassembled by anyone other than a CDI accredited service center
- Damaged in transport or subjected to rough handling
- Damaged due to rodent, pest, or related infestation
- Damaged due to commercial use (stores, restaurants, other businesses, and non-household application)
- Damaged due to accidents, flood, fire, etc.

This warranty does not cover breakable parts and accessories, and any damages due to wear and tear.

The above warranties are given by CDI in lieu of any other warranties, express or implied. CDI and its vendors disclaim any implied warranty of merchantability or fitness for a particular purpose or any similar standard imposed by applicable legislation. CDI's responsibility to repair, replace or offer a refund for defective units, parts and related items is the sole and exclusive remedy provided for breach of these warranties.

MODEL NO. CHBOM3SB0..... **SERIAL NO.**

NOTE: Keep this warranty card together with your Original Sales Invoice /Official Receipt as proof of purchase. If the date of purchase cannot be proven, warranty shall be based on CDI's Invoice to Dealer.



Fill out this warranty card completely and mail within 15 days from date of purchase. This will activate your warranty.

CONDURA

MODEL NO. CHBOM3SB0..... **SERIAL NO.**

DEALER (Please indicate branch)

DATE OF PURCHASE **DEALER INVOICE NO.**

CUSTOMER NAME **EMAIL ADDRESS**

ADDRESS

TELEPHONE NO. **MOBILE NO.**

CONDURA

IBA ANG PINOY

www.condura.com

