

# 重点 校对项

- 1. 版面尺寸
- 2. 材质标注
- 3. 物料编码
- 4. 颜色标注
- 5. 客户型号
- 6. 产品名称
- 7. 重量标注
- 8. 电压功率
- 9. 说明书装订要求
- 10. 警语/认证标志高度
- 11. 档位、控制面板一致性

1	2	3	4	5	6
项目					
库					
文件名					

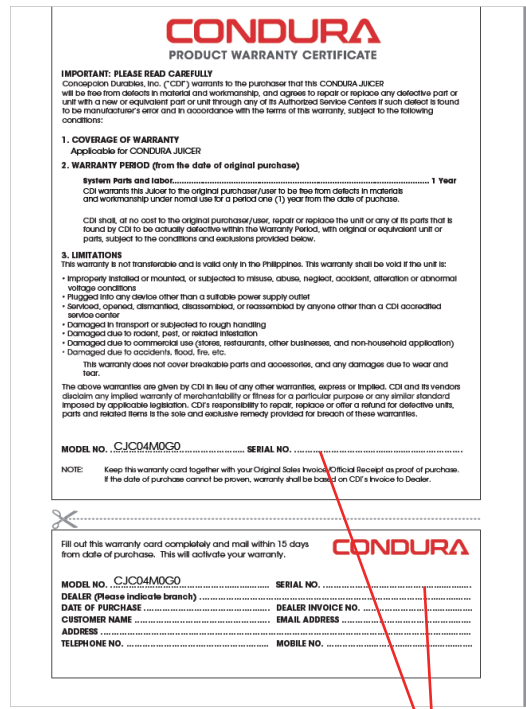
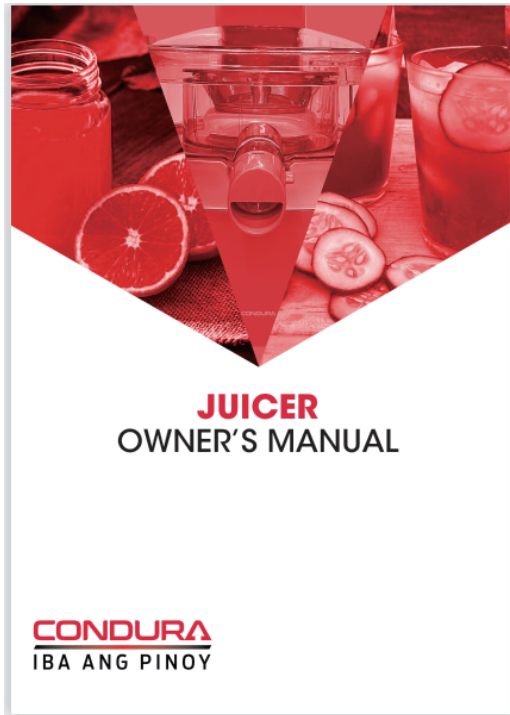

按清单备注  
规则：20033(固定不变)+周两位+年两位+0000固定不变+5位数流水号(流水号每批从100开始)

### 技术要求(版本号:B, 2020-01)

1. 文字图案印刷颜色为：\_\_\_四色\_\_\_，印刷字体需清晰可见，文字不能粘到一起；
2. 该说明书的幅面大小为：\_\_\_A5\_\_\_，未注直线尺寸公差应符合GB/T1804-v；
3. 该说明书的装订方式为：\_\_\_钉装\_\_\_；[70P以下为钉装，70P以上为胶装（特殊要求除外）]
4. 说明书警语及认证标志应满足CE/UL标准，CE：警语部分大写字母高度不低于3mm，CE标志不低于5mm，WEEE标志不低于7mm；UL：大写字母字高不小于1/12”（2.11mm），小写字母字高不小于1/16”（1.6mm），“IMPORTANT SAFEGUARDS”，“SAVE THESE INSTRUCTIONS”等词，其字高不小于3/16”（4.8mm），IMPORTANT SAFEGUARDS 必须在最前面。
5. 产品应符合QMG-J53.021《产品说明书技术条件》的有关要求。
6. 有ROHS指令要求的物料应符合美的的企业标准QML-J11.006《产品中限制使用有害物质的技术标准》。

16164000A08106

				<b>榨汁机</b>		CONDURA-MJ-JE35G2 (CJCO4M0G0)-0501	
				<b>说明书</b>		材料：105g铜版纸	
标记	处数	更改文件号	签字	日期	图样标记	重量	比例
制图		莫培新	审核	卢灿飞	K	/	1:1
设计		-----	标准化	古广君			
校对		-----	审定	古广君	共 1 页		第 1 页
会签		-----	日期	2021-10-29			

广东美的生活电器制造有限公司



# **JUICER**

## **OWNER'S MANUAL**

**CONDURA**  

---

**IBA ANG PINOY**



## IMPORTANT SAFEGUARDS

When using electrical appliances, basic safety precautions must be followed to reduce the risk of fire, electrical shock and injury to persons or properties. Read all instructions before using your Condura Juicer.

1. Read and understand all instructions.
2. Before connecting the appliance to the power supply, make sure that the voltage stated on the rating label of the appliance corresponds with the voltage in your home.
3. Only connect the juicer to a grounded power outlet.
4. Ensure that the plug is inserted firmly into the power outlet.
5. As protection against fire, electric shock and injury to persons, do not immerse the appliance, cord and plug in water or any other liquid.
6. Do not rinse the appliance under running water. Use only a soft, damp cloth to clean the outer surfaces.
7. Do not allow the cord to get in contact with hot surfaces, carpets or other heat insulators.
8. Keep the power cord out of children's reach. Do not let the power cord hang over the edge of the table or countertop where the juicer stands.
9. Do not plug the juicer to a power outlet, or touch the power switch with wet hands.
10. Do not operate any appliance with a damaged cord or plug, after the appliance malfunctions or has been damaged in any manner. Contact Condura's customer service hotline for examination, repair or adjustment.
11. The use of accessories not recommended by the manufacturer may result in fire, electric shock or injury to persons. Do not use other accessories to switch the juicer on/off.
12. Do not leave the juicer operating while unattended.
13. Do not use the appliance for any other use other than what it is intended for.
14. Unplug from power outlet immediately after use, before opening the safety lock and before cleaning. Ensure that the juicer is unplugged when not in use.
15. Do not use the appliance if the rotating sieve or the protecting cover is damaged or has visible cracks.
16. To disconnect, switch off the appliance and remove the plug from the power outlet. Always pull by the plug. Do not pull the cord.
17. Avoid touching sharp blades, especially during cleaning or while the juicer is still connected to the power outlet.
18. If the blades get stuck, unplug the juicer before removing ingredients that are blocking the blades. Use a spatula to remove obstructions. Do not use your bare hands.
19. Make sure that the blade unit is securely fastened to the accessories before assembling on the motor unit.
20. Ensure that all parts are properly assembled before switching on the appliance.
21. Place the juicer on a flat and stable surface.
22. Ensure that both clamps are locked before use. Only unlock the clamps after you have switched off the appliance and when the sieve has stopped rotating.

23. Switch off and unplug the juicer from the power supply before removing and installing parts.
24. Allow the juicer to cool down before cleaning or moving the appliance.
25. Do not remove parts from the juicer while it is operating.
26. Do not reach into the feeding tube, sieve or juice collector while the juicer is running.
27. Do not exceed quantities and processing time indicated in the juicing guide section.
28. Food coloring can discolor parts. This is normal and has no impact on usage.
29. Clean the juicer as instructed in the "Cleaning and Maintenance" section of this manual after each use.
30. Ensure that all parts are properly installed before switching on the juicer.
31. Close supervision is necessary when any appliance is used by or near children.
32. This appliance can be used by children ages 8 years and above, and persons with reduced physical, sensory or mental capabilities or lack of experience and knowledge if they have been given supervision or instructions concerning the use of the appliance in a safe way and understand the hazards involved. Children shall not play with the appliance. Cleaning and user maintenance shall not be made by children unless they are older than 8 and supervised. Children below 8 years of age shall be kept away from the appliance unless continuously supervised.
33. Children must not play with the appliance.
34. This appliance is intended to be used in household and similar applications such as:
  - a. staff kitchen areas in shops, offices and other working environments;
  - b. by clients in hotels, motels and other residential type environments;
  - c. farm houses;
  - d. bed and breakfast type environments.
35. Save these instructions for future reference.

## PRODUCT SPECIFICATIONS

Model	CJC04M0G0
Rated Voltage	230V~60Hz
Power Input	350W
Product Dimensions	276 x 207 x 223 mm
Net weight	2.7 kg

## PARTS

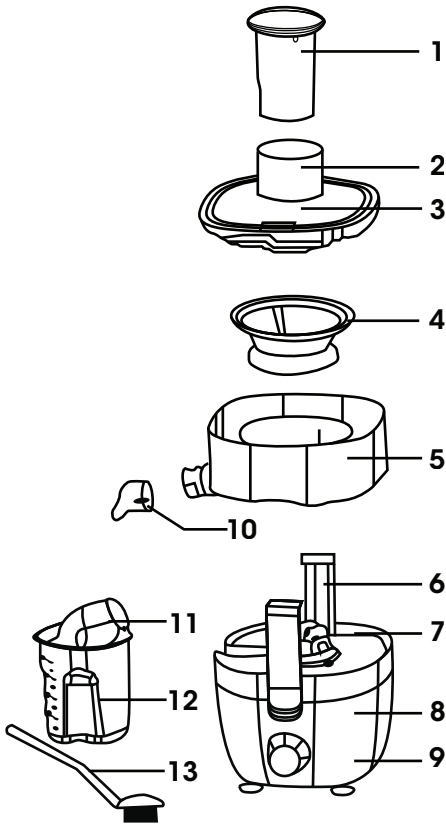

1. Pusher
2. Feeding tube
3. Lid
4. Sieve
5. Juice collector
6. Locking clips
7. Driving shaft
8. Motor unit
9. Control knob
10. Spout
11. Juice container cover spout
12. Juice container
13. Brush

## BUILT-IN SAFETY LOCK

This feature ensures that you can only switch on the juicer if the parts are assembled on the motor unit properly. If the parts are correctly assembled, the built-in safety lock will be unlocked.

## OVERHEAT PROTECTION

This appliance is equipped with overheat protection. If the juicer overheats, it will automatically stop working. To resume operation, unplug the juicer and allow to cool down for 10 minutes. After the juicer has cooled down, plug the juicer back into the power supply, and switch the juicer back on.

## **BEFORE FIRST USE**

1. Remove all accessories.
2. Clean the parts of the juicer before first use by following the steps under "Cleaning and Maintenance".
3. Make sure that all the parts are completely dry before using the juicer.  
Note: To prevent injuries, exercise caution when cleaning/handling the sieve

## **OPERATING INSTRUCTIONS**

Caution: Before plugging the juicer to the power outlet, ensure that the parts are properly installed, and that the control knob is in the "0" or off position.

### **Extracting Juice:**

1. Clean and cut large ingredients into pieces that will fit the feeding tube.
2. Assemble all parts and ensure that the clamps are locked in place.
3. Install the juice container on the juicer spout.
4. Turn the control knob to the desired speed.
5. Put ingredients through the feeding tube.
6. Gently push down the ingredients with the pusher.

Note:

- Pulp, seeds and skin will be separated from the juice.
- Do not exert too much pressure on the pusher, since this would affect the quality of the juice and can cause the sieve to stop rotating.
- Do not run the juicer continuously for more than 2 minutes. If you have not finished extracting juice, switch the juicer off and allow it to cool down to room temperature before resuming operation.
- Do not reach into the sieve through the pulp outlet of the pulp collector.

Tips:

- Remove seeds from fruits with bigger and harder seeds such as cherries, plums, peaches, etc.
- Seeds from fruits like melons, apples and grapes do not need to be removed. The seeds will automatically be separated from the juice.
- Thin peels and seeds do not need to be removed. Only remove thick peels (e.g. oranges, pineapples and uncooked beetroots).
- Remove the white pith of citrus fruits as this has a bitter taste.
- Use fresh fruits and vegetables as they contain more juice. Fruits and vegetables that are recommended for to be juiced are pineapples, beetroots, celery stalks, apples, cucumbers, carrots, spinach, melons, tomatoes, oranges and grapes.

- When juicing apples, note that the thickness of the apple juice will depend on the kind of apple being used. The juicier the apple, the thinner the juice. Choose an apple that will produce the type of juice that you prefer.
- Fruits that contain starch such as bananas, papayas, avocados, figs and mangoes are not suitable for processing in the juicer. Use a food processor, blender or bar blender to process these fruits.
- Leaves and stalks (e.g. lettuce) can also be processed in the juicer.
- Drink the juice immediately after extraction. If the juice is exposed to air for some time, it will lose its taste and nutritional value.
- Apple juice turns brown very quickly. You can slow down this process by adding a few drops of lemon juice.
- You can get more juice output by using softer force to push the fruits and vegetables down.

## JUICING GUIDE

FRUITS/VEGETABLES	WEIGHT	SPEED SETTING
Melons Oranges Lemon Grapes Berries Tomatoes Cucumbers Spinach	500g	1
Apples Pear Pineapples Carrots Celery Beetroots	500g	2



## CLEANING AND MAINTENANCE

Caution: Unplug the appliance and allow the juicer to cool down before cleaning. As protection against fire, electric shock and injury to persons, do not immerse cord or plug in water or any other liquid.

Clean the juicer and its parts after each use by following the steps below:

1. Detach the parts, including rubber rings and clean with lukewarm water and dishwashing soap.
2. Rinse all accessories under running water.
3. You may also use the brush to clean parts.
4. Clean the motor unit with a soft, damp cloth.

Note:

- All detachable parts and accessories are dishwasher safe.
- Do not use scouring pads, abrasive cleaning agents or chemicals such as petrol, acetone or alcohol to clean the appliance.

## STORAGE

1. Ensure that the parts have been cleaned and dried thoroughly before storing to avoid rusting.
2. Store the juicer in a cool, dry place.
3. The plug can be inserted in the main unit for storage.

## TROUBLESHOOTING GUIDE

PROBLEM	SOLUTION
The juicer is not working	<ul style="list-style-type: none"><li>• The juicer is equipped with a safety system. If the parts are not properly connected to the motor unit, the juicer will not work. Check whether the parts are installed correctly before switching the juicer on.</li><li>• The juicer is equipped with overheat protection. If the appliance overheats, it will automatically stop working. Unplug the juicer and let it cool down for 10 minutes. After the juicer has cooled down, plug the juicer back into the power supply, and switch the juicer back on.</li></ul>
The blade/motor unit is blocked  The motor unit emits an unpleasant smell during the first few uses	<ul style="list-style-type: none"><li>• Turn off the juicer and process smaller quantities at a time.</li><li>• This is normal for the first few operation cycles. If the juicer continues to emit unpleasant smell, check the quantity being juiced, application time and speed setting. Make sure to follow the recommended weight and setting as indicated in the juicing guide section.</li></ul>
The sieve of the juicer comes in contact with the feeding tube or vibrates during processing	<ul style="list-style-type: none"><li>• Turn off the juicer and check if the sieve is properly installed. The ribs on the bottom of the sieve should properly fit the motor coupling opening.</li><li>• Check for any damages on the sieve. Cracks, fissures, loose grater disc or any other irregularity may cause the sieve to malfunction.</li><li>• Check and ensure that the rubber ring is assembled properly.</li></ul>

# Customer Care

We are committed to serve.

## **QUESTIONS ABOUT YOUR CONDURA JUICER**

Please feel free to contact any of our customer care hotline:

### **CUSTOMER SERVICE DEPARTMENT**

#### **GMA & LUZON Area**

Address: 308 Sen. Gil Puyat Avenue, Makati City

Trunk Line: (02) 8 863 5555

TOLL FREE: 1800 10 888 8888

Mobile Number: +63 917 536 3030 (Globe) "SMS Only"  
+63 947 996 2415 (Smart) "SMS Only"

Covered Region/Areas: National Capital Region (NCR), Ilocos Region (Region 1), Cordillera Administrative Region (CAR), Central Luzon (Region III), CALABARZON (Region IV-A), MIMAROPA except Romblon (Region IV-B), Bicol Region except Masbate (Region V)

Email Address: [customercare@condura.com](mailto:customercare@condura.com)

#### **CEBU Regional Office**

Address: Dr. A Esperanza Building, A.C Cortes Ave. Mandaue City

Telefax No: 032 328 1416

Mobile Number: +63 947 996 2416  
+63 921 222 0942

TOLL FREE: 1800 10 888 8888

Covered Region/Area: Masbate, Central Visayas (Region VII), Eastern Visayas (Region VIII)

#### **ILOILO Regional Office**

Address: 109 Yulo Street, Brgy. Yulo-Arroyo, Iloilo City, Iloilo

Telefax No: 032 36 1121

Mobile Number: +63 947 996 2417  
+63 999 925 5736

TOLL FREE: 1800 10 888 8888

Covered Region/Area: Romblon, Western Visayas (Region VI)

#### **CAGAYAN DE ORO Regional Office**

Address: No. 102 CKY Center, Capistrano-Chavez Street, CDO City

Telefax No: 08822 721 905

Mobile Number: +63 947 996 2419  
+63 939 253 5011

TOLL FREE: 1800 10 888 8888

Covered Region/Area: Zamboanga Peninsula (Region IX), Northern Mindanao (Region X), Autonomous Region in Muslim Mindanao (ARMM) except Maguindanao, Agusan Del Norte, Surigao del Norte

#### **DAVAO Regional Office**

Address: 1C, Nand-Saling Building, Sobrecarey Street, Obrero, Davao City

Telefax No: 082 224 5040

Mobile Number: +63 947 996 2418  
+63 922 294 1478

TOLL FREE: 1800 10 888 8888

Covered Region/Area: Davao Region (Region XI), SOCCSKSARGEN (Region XIII), Agusan Del Sur, Surigao del Sur, Maguindanao

All contact information detailed above may change without prior notice.



### **CONCEPCION DURABLES INCORPORATED**

### **CUSTOMER SERVICE DEPARTMENT**

**308 Sen. Gil Puyat Avenue, Makati City**

**Trunk Line: (02) 8 863 5555**

**TOLL FREE: 1800 10 888 8888**

**Mobile Nos.: 0917 536 3030 (Globe)  
0947 996 2415 (Smart)**

**PO BOX 211 COMMERCIAL CENTER**

**MAKATI CITY**

**BUSINESS REPLY!  
Permit No. 2416A!  
NO STAMP NEEDED**

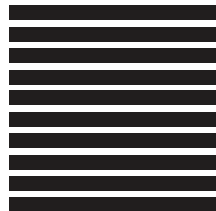

# CONDURA

## PRODUCT WARRANTY CERTIFICATE

### IMPORTANT: PLEASE READ CAREFULLY

Concepcion Durables, Inc. ("CDI") warrants to the purchaser that this CONDURA JUICER will be free from defects in material and workmanship, and agrees to repair or replace any defective part or unit with a new or equivalent part or unit through any of its Authorized Service Centers if such defect is found to be manufacturer's error and in accordance with the terms of this warranty, subject to the following conditions:

### 1. COVERAGE OF WARRANTY

Applicable for CONDURA JUICER

### 2. WARRANTY PERIOD (from the date of original purchase)

**System Parts and labor..... 1 Year**

CDI warrants this Juicer to the original purchaser/user to be free from defects in materials and workmanship under normal use for a period one (1) year from the date of purchase.

CDI shall, at no cost to the original purchaser/user, repair or replace the unit or any of its parts that is found by CDI to be actually defective within the Warranty Period, with original or equivalent unit or parts, subject to the conditions and exclusions provided below.

### 3. LIMITATIONS

This warranty is not transferable and is valid only in the Philippines. This warranty shall be void if the unit is:

- Improperly installed or mounted, or subjected to misuse, abuse, neglect, accident, alteration or abnormal voltage conditions
- Plugged into any device other than a suitable power supply outlet
- Serviced, opened, dismantled, disassembled, or reassembled by anyone other than a CDI accredited service center
- Damaged in transport or subjected to rough handling
- Damaged due to rodent, pest, or related infestation
- Damaged due to commercial use (stores, restaurants, other businesses, and non-household application)
- Damaged due to accidents, flood, fire, etc.

This warranty does not cover breakable parts and accessories, and any damages due to wear and tear.

The above warranties are given by CDI in lieu of any other warranties, express or implied. CDI and its vendors disclaim any implied warranty of merchantability or fitness for a particular purpose or any similar standard imposed by applicable legislation. CDI's responsibility to repair, replace or offer a refund for defective units, parts and related items is the sole and exclusive remedy provided for breach of these warranties.

**MODEL NO.** CJC04M0G0..... **SERIAL NO.** .....

**NOTE:** Keep this warranty card together with your Original Sales Invoice/Official Receipt as proof of purchase. If the date of purchase cannot be proven, warranty shall be based on CDI's Invoice to Dealer.



Fill out this warranty card completely and mail within 15 days from date of purchase. This will activate your warranty.

# CONDURA

**MODEL NO.** CJC04M0G0..... **SERIAL NO.** .....

**DEALER (Please indicate branch)** .....

**DATE OF PURCHASE** ..... **DEALER INVOICE NO.** .....

**CUSTOMER NAME** ..... **EMAIL ADDRESS** .....

**ADDRESS** .....

**TELEPHONE NO.** ..... **MOBILE NO.** .....



**CONDURA**

**IBA ANG PINOY**

**[www.condura.com](http://www.condura.com)**

